

PRODUCT DATA SHEET

TNF30025/125/250
TNP30500

Sneakers Soft Maker

- Paint Softener
- Fabric Medium Additive
- To paint with the sneakers paint on fabric, mesh, canvas and denim.

-QR code:

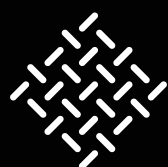

EN



Denim



Mesh



Canvas

Sneakers Soft Maker

Additive to mix with the sneakers paint, to be used on fabric, mesh, canvas and denim. Keeps the surfaces soft and flexible while sets the paint on them for a better finish.

Surfaces



FABRIC, MESH, CANVAS AND DENIM

Use



PAINT SOFTENER

Can apply it with



Presentation

PACKAGE	BOX UNITS	BOX SIZES	BOX WEIGHT	PALLET UNITS	EAN CODE
25 ml - 0.9 fl oz glass bottle	12 display box	14 x 7 x 10.5 cm	0.98 kg	-	8427457567269
125 ml - 4.2 fl oz plastic bottle	4	11 x 15.5 x 7.5 cm	0.74 kg	-	8427457567276
250 ml - 8.8 fl oz plastic bottle	10	21.5 x 17 x 22 cm	3.24 kg	2.304	8427457567283
500 ml-16.91 fl oz	-	-	-	-	8427457567290

How to use

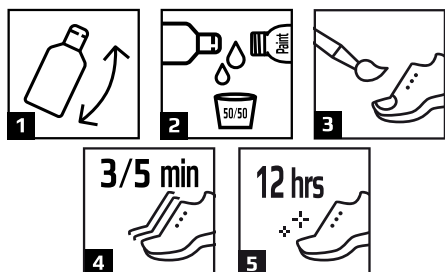

1. Shake the bottle before use.
2. Mix the Soft maker with the Sneakers Paint in a 50/50 ratio.
3. With a paintbrush apply the mixture in multiple thin coats, until you obtain the desire coverage.
4. Let it dry between 3/5 minutes between layers.
5. For optimum drying, leave it dry for 12 hours.

Tips and Characteristics

- For a better result on dark surfaces, we recommend painting before with sneakers paint white and soft maker.
- To set the paint better on the surface we recommend using a heat gun or a hair dryer to dry the paint between layers and at the end.
- Can use the product mixing with sneakers paint in all fabric areas of the sneakers, but it has to be applied correctly.