

# PRODUCT DATA SHEET

**TNC10900025A**

## GLOW IN THE DARK

-The only paint with a water-based photoluminescence color dye.

-Specially formulated to customize your smooth leather, synthetic leather or canvas sneakers.

-Offers a high endurance and a perfect finish.

-QR code:



PAINT

**TARRAGO BRANDS INTERNATIONAL**

Narcís Monturiol 18, Pol. Industrial Bufalvent  
08243. MANRESA - SPAIN +34 93 877 08 14

[WWW.TARRAGO.COM](http://WWW.TARRAGO.COM)



## Glow In The Dark

Is the only paint with a water-based photoluminescence color specially formulated to customize your smooth leather, synthetic leather or canvas sneakers.

### Surfaces



LEATHER



CANVAS

### Use



PAINT

## Description

Its matt finish and unique formulation, evidence a high endurance and a perfect finish. After different studies in our laboratory we evidence to conclude that it offers a high resistance to wet/dry friction and flexions preventing the dye from cracking and keeping the customize in perfect conditions.

## Characteristics



900 - Green Glow

## Presentation

PACKAGE	BOX UNITS	BOX SIZES	BOX WEIGHT	PALLET UNITS	EAN CODE
Glass bottle 25 ml - 0.9 fl oz	6	14.7 x 10.2 x 10.5 cm	0,58 Kg.	4.620	8427457575608

## Extra Information

- Glow In The Dark is specially formulated for sneakers.
- To enhance the brightness expose to sunlight for a few hours.
- The process of phosphorescence is in which energy absorbed by a substance is released slowly in light form. So, it is important to know that this product emits light slowly, enough to be seen at night or with the lights off.
- During the first 3-4 hours the effect is lighter and brighter, and then the effect loses the brightness and light slowly until 6 hours. After that, you have to recharge it with the natural or artificial light.
- This product emits small quantity of light, so the effect is more lasting than the time exposed to light.
- Lasting photoluminescence painting: 20 years.
- Glow In The Dark, is in accordance with the updated legislation on health, safety and environment. As a water-based formula, it is not considered a hazardous product for the consumer or the environment.

## — How to use

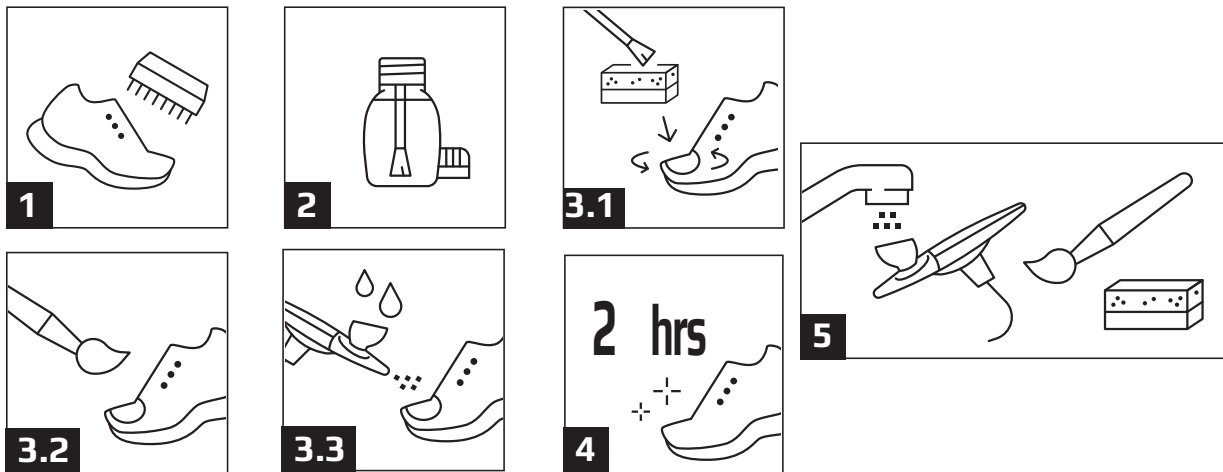

1. Clean the sneakers with the Sneakers Cleaner using the Sneakers Brush or the Tarrago Shoe Duster. For best dyeing results, use the Tarrago Conditioner.
2. Before painting, stir the content with the brush enclosed, until a homogeneous color is obtained.
3. Customize your sneakers:
  - 3.1. Use the sponge included to cover larger surfaces. With the semi-wringing paint brush, paint one corner of the sponge and gently rub over with circular moves on the Sneakers.
  - 3.2. Use the Paint Brush included for small details or customization.
  - 3.3. Use an Airbrush. Use the neutral base (50% neutral base and 50% Glow In The Dark), to dilute the paint and maintain its properties.

It is better to apply three to five layers as required by luminescence intensity. After drying the first layer of paint (1 hour), apply a second layer if it is necessary, repeating the operation to match the entire color. To accelerate the dyeing process between layers, use a hair dryer with caution (30 cm. minimum distance). Apply the Glow In The Dark to the white surface. If the surface is not white apply the Sneakers Paint nº 1 (white color) previously.

4. For optimum drying, let it dry for 2 hours.
5. Once the process is finished, wash the Sponge, the Paint Brush or the Airbrush with water to prevent them from drying out.

**TIP:** For a better result use an ultraviolet flashlight to see outline paint.

**TIP:** When the paint is dry to improve the resistance we recommend to use the Sneaker Paint Neutral Base.